

GRIND-O-FLEX

ABRASIVE FLAP WHEELS

MINIATURE GRIND-O-FLEX

1" to 3" dia.

Type XX Aluminum Oxide, Resin Bond "X" wt. cloth
QUICK CHANGE FEATURE enables user to change
wheels.

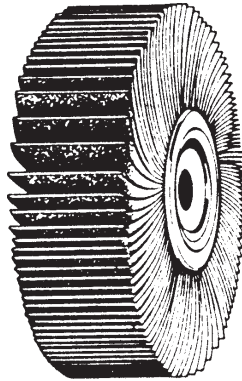
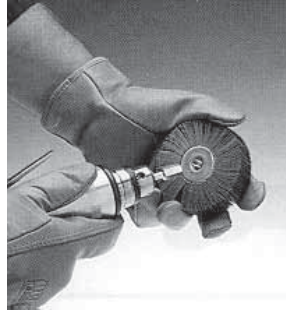

Metal, Plastic and Wood
Contoured Finishing.

| PRODUCT NUMBER | WHEEL DIA X W | 1-9 WHEELS | 10-50 WHEELS |
|----------------|-----------------|------------|--------------|
| XX-0015 | 1 x 5/8" | \$3.59 | \$3.04 |
| XX-0011 | 1 x 1" | 3.78 | 3.20 |
| XX-1306 | 1-3/8 x 5/8" | 3.59 | 3.04 |
| XX-1505 | 1-5/8 x 1/2" | 4.37 | 3.70 |
| XX-1510 | 1-5/8 x 1" | 4.89 | 4.15 |
| XX-2005 | 2 x 1/2" | 5.11 | 4.34 |
| XX-2007 | 2 x 3/4" | 5.54 | 4.71 |
| XX-2010 | 2 x 1" | 6.06 | 5.15 |
| XX-2501 | 2-1/2 x 1/4" | 4.95 | 4.20 |
| XX-2503 | 2-1/2 x 3/8" | 4.95 | 4.20 |
| XX-2505 | 2-1/2 x 1/2" | 5.41 | 4.59 |
| XX-2510 | 2-1/2 x 1" | 6.85 | 5.83 |
| XX-3005 | 3 x 1/2" | 5.86 | 4.99 |
| XX-3007 | 3-3/4" | 6.85 | 5.83 |
| XX-3010 | 3 x 1" | 7.38 | 6.28 |
| XX-3020 | 3 x 2 x 3/8" AH | 12.07 | 9.66 |

* Denotes In Stock Items

GRIND-O-FLEX WHEELS 6" DIA.

Max. RPM 6000, Type K
Aluminum Oxide Glue Bond "J" wt. cloth

| PART# | D X W X AH X GRIT | PRICE |
|-----------|----------------------|-------|
| K-061100 | 6X1X1 100X | 19.81 |
| K-061120 | 6X1X1 120X | 24.60 |
| K-061180 | 6X1X1 180X | 27.02 |
| K-061240 | 6X1X1 240X | 27.02 |
| K-061320 | 6X1X1 320X | 27.02 |
| K-06140 | 6X1X1 40X | 21.02 |
| K-0615120 | FLP WHL 6X1-1/2 120X | 27.90 |
| K-0615180 | FLP WHL 6X1-1/2 180X | 30.82 |
| K-0615240 | FLP WHL 6X1-1/2 240X | 30.82 |
| K-0615320 | FLP WHL 6X1-1/2 320X | 30.82 |
| K-061540 | FLP WHL 6X1-1/2 40X | 20.70 |
| K-061560 | FLP WHL 6X1-1/2 60X | 23.80 |
| K-061580 | FLP WHL 6X1-1/2 80X | 24.57 |
| K-06160 | 6X1X1 60X | 21.54 |
| K-06180 | 6X1X1 80X | 22.67 |
| K-062120 | 6X2X1 120X | 41.85 |
| K-062180 | 6X2X1 180X | 45.87 |
| K-062240 | 6X2X1 240X | 45.87 |
| K-062320 | 6X2X1 320X | 45.87 |
| K-06240 | 6X2X1 40X | 35.20 |
| K-06260 | 6X2X1 60X | 35.97 |
| K-06280 | 6X2X1 80X | 37.80 |
| XX-063320 | 6X3X1 320X | 58.29 |

ADAPTERS FOR MINIATURE GRIND-O-FLEX WHEELS

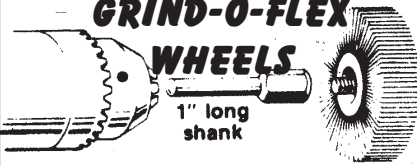

1/4" SHANK ADAPTER
#QC-4 ITEM CODE # 37001

\$1.23

1/4" SHANK EXTENSION ADAPTERS

| MODEL NUMBER | SHANK LENGTH | CODE NUMBER | PRICE |
|--------------|--------------|-------------|-------|
| QC-8 | 1/8 x 1" | 37002 | 3.94 |
| QC-44 | 4" | 37003 | 4.82 |
| QC-46 | 6" | 37004 | 5.31 |
| QC-48 | 8" | 37005 | 8.10 |

MOUNTING ADAPTERS FOR GRIND-O-FLEX WHEELS 3-1/2" TO 12" DIA.

1/4" SHANK ADAPTERS FOR 3-1/2" TO 8" WHEELS

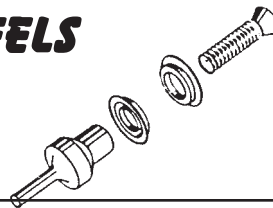

| WHEEL SIZE | O.E.N. | PRODUCT NUMBER | PRICE |
|--------------------------------|--------|----------------|-------|
| 3-1/2" Dia. | 25001 | MA-300 | 11.56 |
| 4, 5, 6, 8" Dia | 25003 | MA-400/600 | 11.13 |
| 3/8" Dia Shank for 3-1/2" Dia. | 25007 | MA-338 | 11.03 |

THREADED SPINDLE MOUNTING ADAPTER

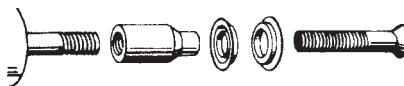

MAT-400/600 3/8-24
THREAD

\$11.13

REDUCER BUSHINGS FOR 6 & 8" DIA. WHEELS

| | | | |
|------|-------|--------|----------|
| 1/2" | 25017 | RB68 | 1.22 pr. |
| 5/8" | 25018 | RB68TP | 1.22 pr. |

Also available 3/8", 3/4", 7/8"
Specify arbor hole size when ordering



137

INDUSTRIAL PIPE & STEEL CO.
9936 Rush Street
South El Monte, CA 91733



NATIONWIDE 800-423-4981
Local Number (626) 443-9467
Fax Number (626) 579-4602

137

UPDATE 01-04-06